

9.17.4 (2017-07-12)

Test script generated with testIDEA can now export coverage in format suitable for Cobertura plugin in Jenkins. This way we can see coverage trend on the project page in Jenkins. See testIDEA help, section *Tasks | Continuous Integration with iSYSTEM and Jenkins* for details.

Project itest

add description
Disable Project

Code Coverage
Packages 100% Files 100% Classes 100% Methods 100% Lines
100% Conditionals 100%

Test Result Trend

Build History trend

Build	Time
#130	May 10, 2017 10:49 AM
#129	May 10, 2017 10:48 AM
#128	May 10, 2017 10:47 AM
#127	May 10, 2017 10:44 AM
#126	May 10, 2017 10:42 AM
#125	May 10, 2017 10:41 AM
#124	May 10, 2017 10:39 AM
#123	May 10, 2017 10:38 AM
#122	May 10, 2017 10:23 AM

Permalinks

- Last build (#130), 22 sec ago
- Last stable build (#130), 22 sec ago
- Last successful build (#130), 22 sec ago
- Last failed build (#126), 6 min 37 sec ago
- Last unstable build (#129), 1 min 20 sec ago
- Last unsuccessful build (#129), 1 min 20 sec ago
- Last completed build (#130), 22 sec ago

(just show failures) enlarge

9.17.5.0 (20.07.2017)

Improved automatic setting of test IDs

Added start value for $\${_seq}$ when setting test IDs, added new host var $\${_did}$ for testIDs. The new host var hierarchically numbers derived tests, eg 1.3.4.

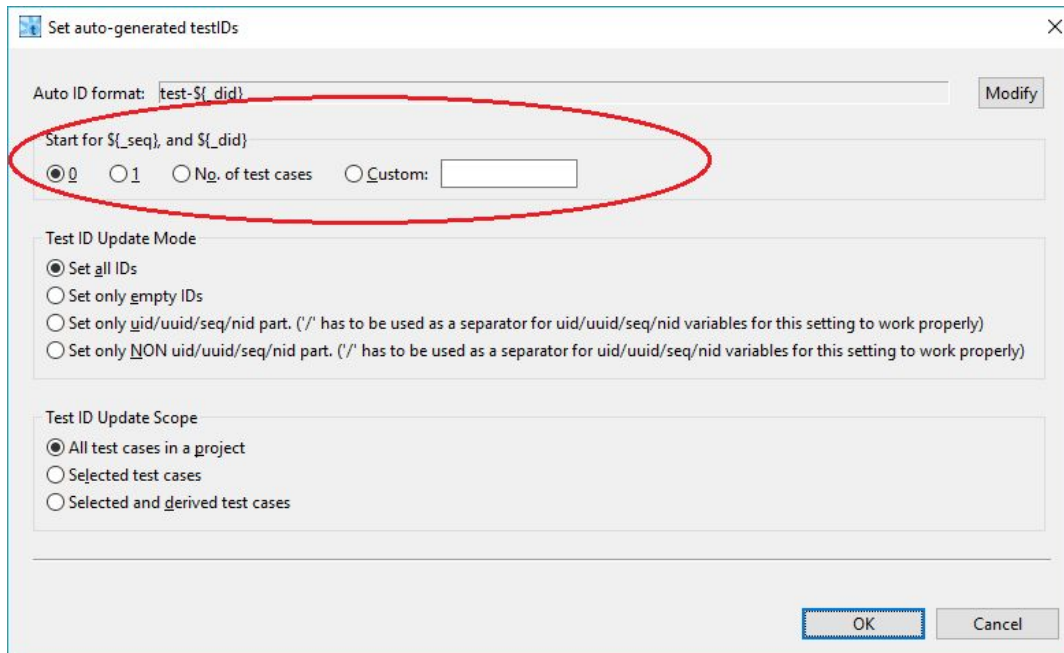

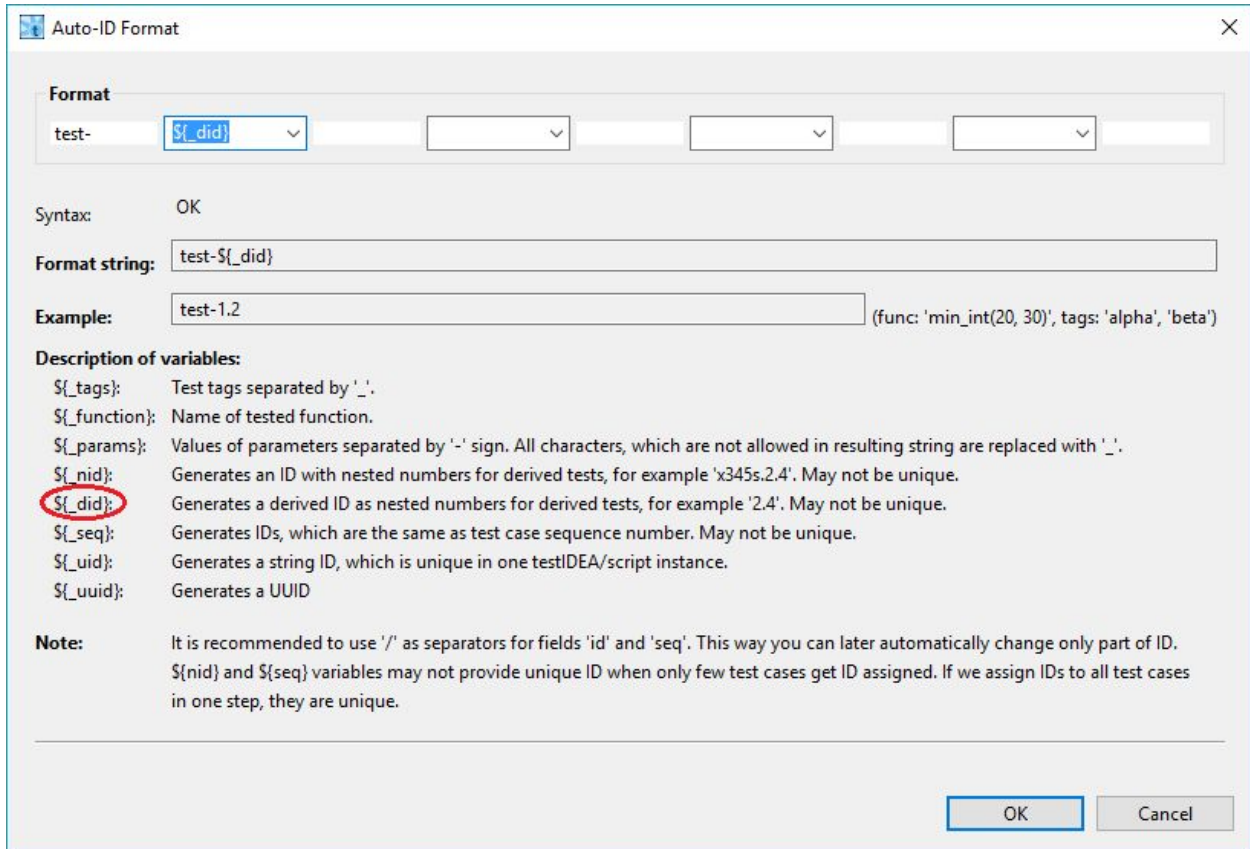

Extrapolation of strings in table editor

If cell with string content is selected for extrapolation in table editor, then its content is copied to all other selected cells.

9.17.6.0 (31.07.2017)

Number of conditions added in function cvrg in groups stats.

Coverage for function in group now contains more detailed info for condition coverage - cond. true, false, and both.

stm32.elf	"src\listUtils.c	"countLessThan	0	/	0.0% (0/72)	0.0% (0f, 0t, 0b) / 4	0
stm32.elf	"src\listUtils.c	"maxElement	1	100.0% (1) / 0.0% (0) / 0.0% (0)	100.0% (72/72)	100.0% (0f, 0t, 2b) / 4	1
stm32.elf	"src\listUtils.c	"minElement	1	100.0% (1) / 0.0% (0) / 0.0% (0)	100.0% (72/72)	100.0% (0f, 0t, 2b) / 4	1
stm32.elf	"src\listUtils.c	"sumList	1	100.0% (1) / 0.0% (0) / 0.0% (0)	100.0% (64/64)	100.0% (0f, 0t, 1b) / 2	1
stm32.elf	"src\pidController.c	"controllerLoop	0	/	0.0% (0/96)	/ (0f, 0t, 0b) / 0	0

Toolbar buttons for collapsing and expanding groups and test cases

Buttons were added to Overview tree. Expand button supports CTRL (expand selected only) and SHIFT (expand selected one level only) modifiers.

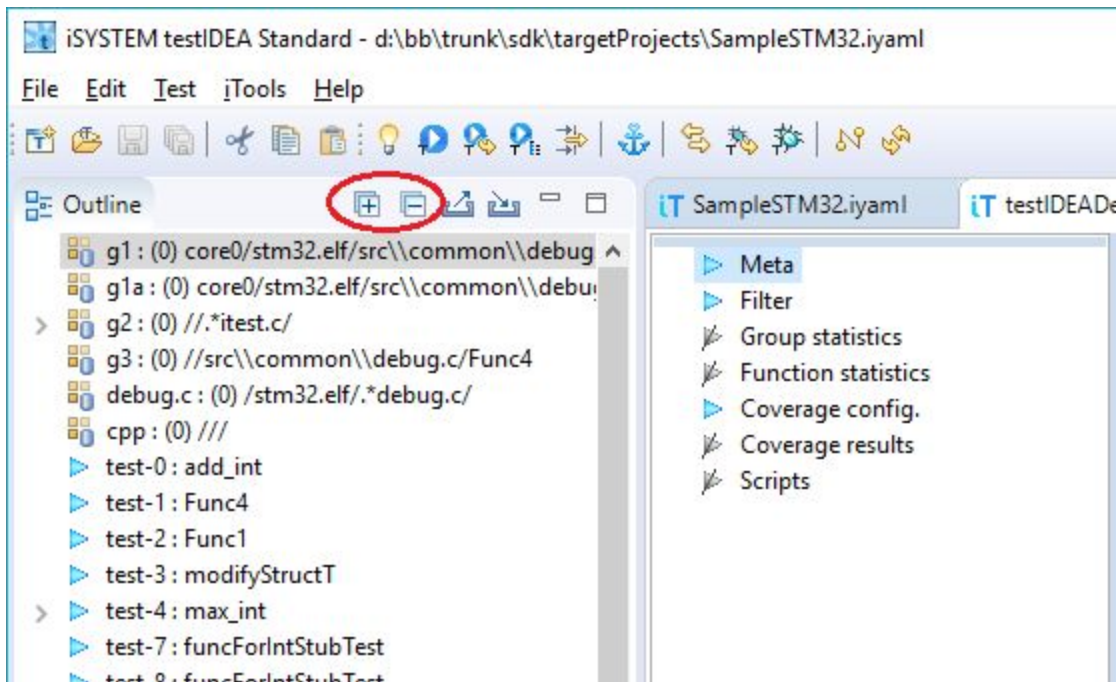

9.17.23.0 (10.11.2017)

0 8.11.2017 Integer truncating changed to proper rounding method in table editor interpolator.